

Rachel Graham

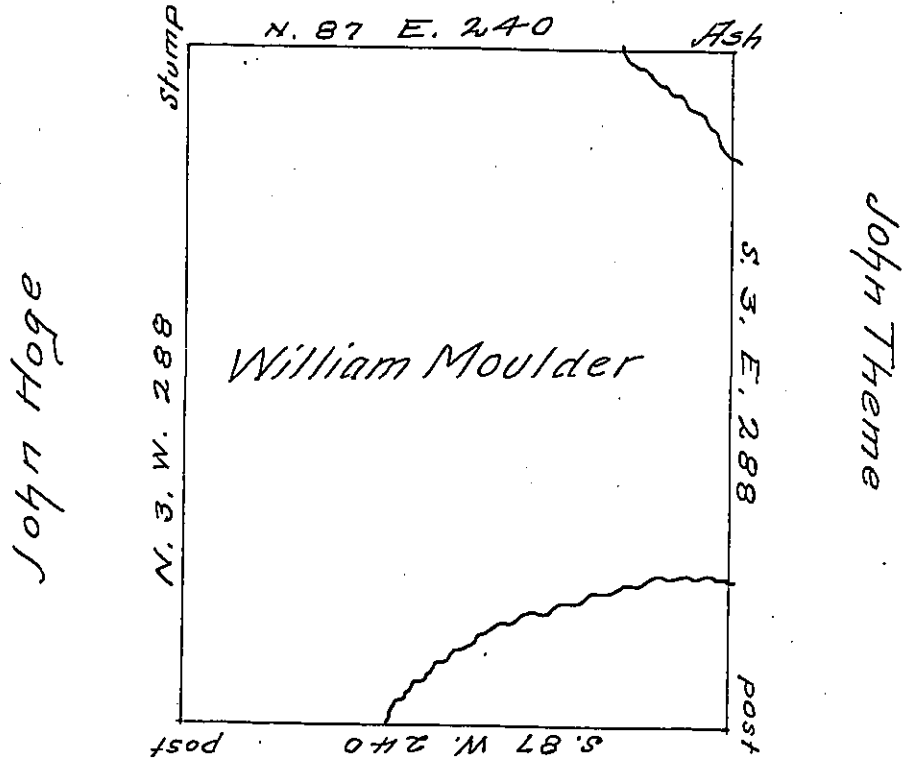

John Lines

Situate on the Waters of Big Beaver Creek in district No. 3
 Allegany County Containing Four hundred and seven acres
 Eighty six perches and allowance. Survey'd 31 May 1796
 in pursuance of a Warrant granted William Moulder 21
 April 1794

Ben. Stokely D.S.

Dan^l Brodhead Esq. S.G.

IN TESTIMONY that the above is a copy of the original remaining on file in
 the Department of Internal Affairs of Pennsylvania, made
 conformably to an Act of Assembly approved the 16th day of
 February, 1833, I have hereunto set my Hand and caused
 the Seal of said Department to be affixed at Harrisburg,
 this eighteenth day of January 1906

Luca R. Brown
 Secretary of Internal Affairs.